

Need 2 Know #56

Locks & Codes	Page 2 – back of entry door, below Welcome
Front Hall Entrance	Page 3 – back of entry door, below Welcome
Kitchen	Page 4 – Fridge, below Welcome
Patio	Page 5 – inside main patio door
Living Room	Page 6 – slide under glass left of TV
Bathroom on Main Floor	Page 7 – back of door
Bathroom on 2 nd Floor	Page 8 – back of main door
Master Bedroom	Page 9 – back of door
Guest Bedroom	Page 10 – back of door
Kids Bedroom	Page 11 – back of door

Notes

Windows - All windows have been permanently closed. This has been done in an effort to reduce premature rusting by keeping the humidity levels below 55%.

A/C Unit - The A/C unit will automatically turn off if any patio door is left open for more than 5 minutes. To turn the system back on, close the doors and set A/C to cool.

Noise – We have many residents & guests, please keep noise level down at all times.

Parking – Only park in your spot identified by the condo number. Unmarked spaces are available on a first come first served basis.

Beach Area – Return all lounge chairs to their storage area under the stairs. Do not take chairs into the water as this promotes premature rusting.

Garbage – Garbage from the unit needs to be removed and placed in the dumpster at the front of the complex, just south of the entrance from the road.

Need 2 Know – Locks & Codes (all access codes will be given upon request)

- One key operates both locks on the front door. Note: you must unlock the top deadbolt first and then the bottom lock.

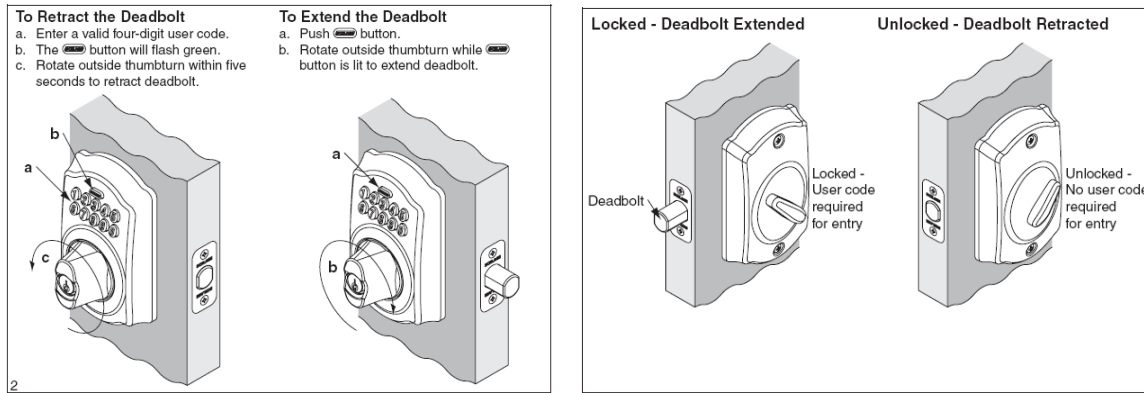

Key Override

NOTE: Key will both extend and retract deadbolt.

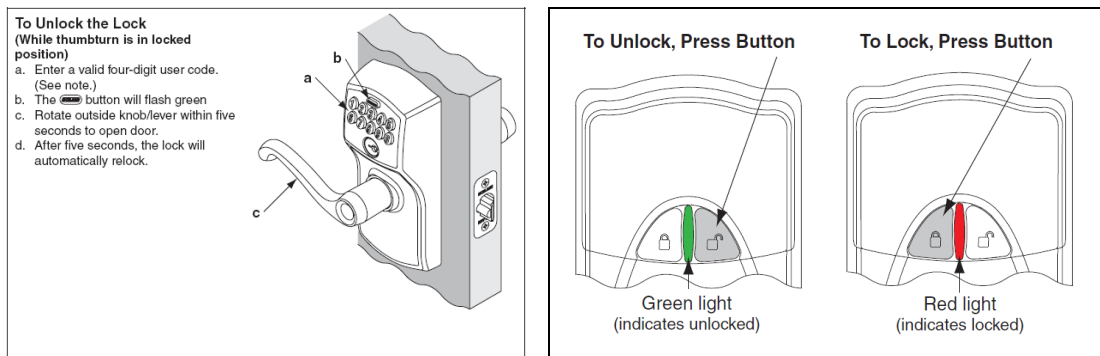
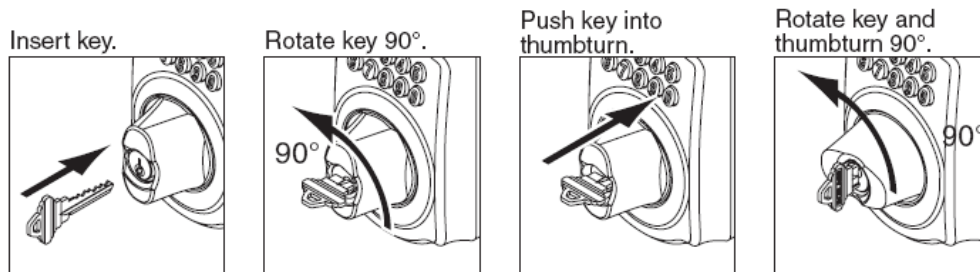

Key Override

NOTE: Key does not retract latch.

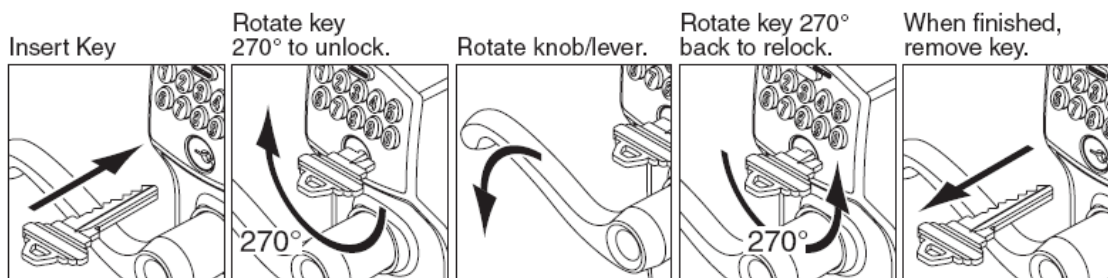

Key cannot be removed in this position.

Need 2 Know – Front Hall Entrance

- Only use high efficiency laundry detergent (ie Tide HE)
- To silence smoke & carbon monoxide detectors, push center button
- Fan/Light in stairway – light can be controlled from top or bottom of stairs and the fan can only be controlled from the top of the stairs
- HVAC system is a single unit with two controls. This unit can be operated from the main floor at the touch panel or from the thermostat at the top of the stairs. The thermostat at the top of the stairs will toggle the display from the current indoor temperature, to the outdoor temperature. If the Hold key is pressed on the thermostat upstairs it will lock out control from the main floor touch panel. Temperature can be controlled on the main floor touch panel by pressing the Temp icon on the screen. A menu will appear where you can select control of the thermostat, or to view the outdoor temp, or outdoor humidity. Note: On touch screen you can always go back to the main menu by pressing the “Home” icon in the bottom right hand corner that looks like a door.
- **To Arm Security System:** On touch screen just outside of main floor bathroom, press the security icon (looks like a lock), this takes you to the security screen. Press the Away button on the security screen and enter your four digit code. The touch screen will immediately start to beep indicating your 30 second count down to depart the unit and lock the front door. The LED light on the touch screen will turn from green to red indicating that the system is armed.
- **To Disarm Security System:** When re-entering the unit if the alarm has been armed, the touch panel will start to emit a constant tone reminding you to disarm the system. The screen will pop up with the Disarm function. Press the Disarm button and enter your four digit code. The LED light will turn from red to green indicating that you have successfully disarmed the system. You have 30 seconds to disarm the system upon entering the unit. Note: On touch screen you can always go back to the main menu by pressing the “Home” icon in the bottom right hand corner that looks like a door
- Security safe can be accessed by entering the access code followed by the letter ‘A’, turn dial and now pull open. To lock, close door and turn dial.
- To enter tennis court, use the key found on one of the sets hanging in the front hall closet. Lights are located on the pole to the North outside of the court.

Inventory

Hoover Windtunnel Bagless Canister Vacuum
Whirlpool Duet HT GHW9250 Front Loading Washer and stacking Dryer YGEW9200
Iron & Ironing Board (located top of the stairs)
Instant On-Demand Hot Water System
Tennis Rackets x 4
Sun Umbrellas x 2

Need 2 Know – Kitchen

- Do not use any abrasives for cleaning
- Use Cerama Bryte, a dry paper towel and rub hard for stove top
- Garbage located to the left of the stove
- Exhaust system above stove
- Water from small tap & fridge is R/O (Reverse Osmosis) water
- Telephone & Cook books located to left of garbage
- All cleaning supplies located under sink
- Dishwashing soap is located in counter mounted dispenser to left of tap
- Floodstop alarm for R/O water system located in base right hand corner cabinet.
- To reset, turn dial. Note: please check for leak first.
- Music System: There is an in-wall CD/Stereo system located beside the telephone just outside the kitchen. It is equipped with a built in CD player, and an FM radio. You may also connect a MP3 device to the jack labeled AUX1 located next to the paper towel holder. To select AUX1, from the main unit, toggle the source button for the appropriate selection. It can be controlled either on the unit itself, or with the thin remote located in the top drawer to the left of the stove that reads "SpeakerCraft". The volume controls on this unit only affect the volume coming out of the kitchen speakers. The master bedroom and both bathrooms are also equipped with speakers but have independent controls for their volume. You may turn the volume all the way down in the kitchen if you would only like to listen in one of the other rooms, but the main unit must remain powered on for other rooms to function.
- Internet radio + iPod/iPhone dock is located on the shelf just right of the sink. Set Music System source to AUX2 and tune in appropriate radio station or iPod/iPhone tunes.

Inventory

Cuisinart CJK-17 Cordless Electric Kettle
 Cuisinart CSB-77C Stick Hand Blender
 KitchenAid 4KSB5SS0 5 Speed Professional Blender
 KitchenAid KMTT400 4 Slice Toaster
 Delonghi Coffee Maker
 Juicer
 Sandwich Maker
 Whirlpool YGY396LXMB Self-Cleaning Electric Range
 Whirlpool GC3SHEXNB Refrigerator
 Whirlpool GU3200XTSB Dishwasher
 Whirlpool YMH7155XMB Microwave Hood Combination
 Grohe Ladylux Plus Faucet
 Water System 4 stage Reverse Osmosis
 6 Wine Glasses
 Henkel 10 Piece Pot Set
 Henkel Cutlery 8 settings
 Henkel 7 Piece Block Set
 Patio Dishes 8 settings
 Patio Glassware 6+6 glasses
 Dinnerware 8 settings
 Pub table & 6 chairs
 Can Opener
 Cork Screw
 Grohe Liquid Soap Dispenser
 Grace Internet Radio GDI-IR3020 - Duet Dock

Need 2 Know – Patio

- BBQ – ensure propane tank is turned on. If it needs to be refilled, please exchange it for a full tank across the street at the Texaco. The condo owners will reimburse you for the cost of the propane (est CI\$40). To remove tank, disconnect and remove from the back of the BBQ.
- Clothes racks are mounted on the wall. To use, flip up the silver cover and extend the rods by pulling away from the wall. To close, flip up silver cover, and push rods towards wall.
- Wireless speaker – press blue button to turn on/off and control volume accordingly. Main unit in kitchen must be on.
- SILVER SECURITY PATIO DOOR LOCKS – Located bottom left of doors. Turn counter clockwise to open and clockwise to engage.

Note: A/C will turn off if doors left open for longer than 5 minutes.

Inventory

Napolean Prestige 450 BBQ

Heidt Seville Patio Furnishings (4 chairs & round table + 2 chairs, ottoman & side table)

Wireless speaker

Need 2 Know – Living Room

- There are two remote controls for the TV/Home theatre system in the living room, both labeled: one for the Digital Cable box, and one for the Panasonic DVD System.
- To Watch TV: There is one black remote, Turn on the TV with small TV button, top left and turn on the cable box, with the main power button, top center. Ensure the TV/Video is set to CABLE using the input button, top right. The volume for the TV is set to the midway point using the volume on the top left of the remote. Adjust the volume and channels using the centrally located volume and channel buttons.
- Note: The Panasonic DVD player on the bottom must be off for TV audio to work.
- To Watch a DVD: On the Panasonic TV/Stereo remote, press the “One Touch Play” button located in the centre of the remote above the circular cursor pad. This will turn on the stereo, DVD, and set the correct inputs. Select the appropriate disc number for the DVD you would like to watch.
- To Watch PVR: Set TV/Video using the main black remote to PVR. Turn on the Iomega unit using the small Iomega remote. Select the appropriate folder and press enter/play.
- DVD movies located in left hand cabinet under TV
- Turning Off System: Press the smaller TV power button. The red indicator on the bottom left of the TV should be off when the TV is off.

- To receive a fax, set to auto or press START while hearing tones.
- Line 1 is for local calls
- Line 2 is for FREE North American calls

- Lexmark E120n is located to the left of the desk.

- Asus computer is mounted on the back of the LCD. To power on, press large round button found on the right hand side of the rear of the LCD on the PC.

Inventory

Panasonic KX-FG6550 2 Line Fax
 Panasonic KX-TGA650CB 5.8GHz Cordless Phone
 Asus Computer
 LG 22” LCD
 Lexmark E120n Laser Printer
 Logitech S100 Speakers
 KB & Mouse
 Computer Desk
 Panasonic 50” HDTV
 Panasonic 5 Disc Changer SCHAT940S
 Iomega Digital PVR
 Leather Sectional
 Leather Chair & Ottoman
 Widescreen TV Stand
 Satellite DVR unit w/Remote

Need 2 Know – Bathroom on Main Floor

- Soft Close Toilet Seat
- Electronic Timers for Exhaust Fan & Shower Lights
- Volume for speakers is outside the door. The source of this music is controlled from the kitchen.

Inventory

Kohler K-3323 One Piece Toilet

<u>Towels</u>	Out	Stored
Face	2	2
Hand	1	2
Body	2	2
Mat	1	1
Beach		6

Need 2 Know – Bathroom on 2nd Floor

- Soft Close Toilet Seat
- Electronic Timers for Exhaust Fan & Shower Lights
- Volume for speakers is to the left of the ensuite door. The source of this music is controlled from the kitchen.

Inventory

Hair Dryer

Magnifying Mirror

Zenith BodyFat Scale 1055WWBA

<u>Towels</u>	Out	Stored
Face	4	4
Hand	1	2
Body	4	4
Mat	1	2

Need 2 Know – Master Bedroom

- All linens for the king bed are located in the closet on the top shelf on the left hand side.
- A down duvet for the master room is stored in the closet on the top shelf on the left hand side. Please store comforter here if using duvet.
- An extra set of queen size pillows are located in the closet in the third bedroom on the top shelf on the right hand side.
- Floor safe is located on the floor inside the closet on the left hand side.
- Dumbbells, and mat are located in the closet on the bottom left.
- Skipping rope, deflated ball, and heating pad are located in the bottom drawer of the night stand.
- Remote for Sanyo DVD-L77 portable DVD is located in the top drawer of the night stand.
- Volume for speakers is to the left of the main door. The source of this music is controlled from the kitchen.

Inventory

Protect-A-Bed pillow and mattress covers
King Size Obus Forme Pillows x 2
Cloud Nine Therapeutic Memory Foam Mattress
Complete Set Of King Sheets x 2
Down Duvet
Nautilus ND-552 Dumbbell
Exercise Mat, Skipping Rope & Ball
Panasonic KX-TGA650CB 5.8GHz Cordless Phone w/Alarm Clock
Sanyo DVD-L77 Portable DVD/Video and Radio Player with remote
Garrison Security Safe

Need 2 Know – Guest Bedroom

- All linens for the queen bed are located in the bottom right drawer of the dresser.
- A down duvet for the guest bedroom is stored in the bottom left drawer of the dresser. Please store comforter on top of the dresser if using duvet.
- An extra set of queen pillows are located in the closet in the third bedroom on the top shelf on the right hand side.

Inventory

Protect-A-Bed pillow and mattress covers

Queen Size Obus Forme pillows x 2

Complete Set Of Queen Sheets x 2

Down Duvet

Cloud Nine Therapeutic Memory Foam Mattress

Sony ICF-C212 Dream Machine Alarm Clock

Need 2 Know – Kids Bedroom

- CAUTION – when on top bunk, be aware of fan.
- All linens for the single bed are located in the closet on the top shelf on the left hand side.
- A down duvet for the single bed is stored in the closet on the top shelf on the left hand side. Please store comforter here if using duvet.
- All linens for the double bed are located in the closet on the top shelf on the left hand side.
- A down duvet for the double bed is stored in the closet on the top shelf on the left hand side. Please store comforter here if using duvet.
- All Xbox 360 accessories are located in the drawer under the window. Please ensure the power bar is turned off when not in use.
- Movies are located in the left hand compartment of the TV stand in the living room.
- Safety gate is located beside the dresser
- High chair is located beside the dresser
- Step ladder is located beside the dresser
- Children car seats are located in the cabinet above the mirror doors
- Safety bed rail is located in cabinet above the mirror doors.
- Playpen is located in the closet on the left hand side.
- Toys are located in the closet on the left hand side.
- Games are located in the cabinet under the window.
- Kayaks must be rinsed and dried after each use.

Inventory

Protect-A-Bed pillow and mattress covers
Standard size Obus Forme pillows x 2
Queen size Obus Forme pillows (in closet) x 2
Complete Set Of Double Sheets x 2
Complete Set Of Single Sheets x 2
Down Duvet x 2
Xbox 360 + Two Controllers with Rechargeable Battery Pack + Game
ViewSonic N3260w LCD w/Remote
Satellite Receiver w/Remote
Child Seat Evenflo Big Kid
Booster Seats x 2
High Chair
Safety Gate
Step Ladder
Fold-N-Go Playpen
Voyager Kayak w/paddle x 2
Bunk Bed (Double & Single)
Safety Bed Rail for Upper Bunk
Double Dresser
Sony ICF-C212 Dream Machine Alarm Clock